

"20 Minute Fire Rated" (Foam Core) OPAQUE FIBERGLASS SINGLE DOOR INSWING/OUTSWING "IMPACT"

GENERAL NOTES

1. This product has been evaluated and is in compliance with the 8th Edition (2023) Florida Building Code (FBC) structural requirements excluding the "High Velocity Hurricane Zone" (HVHZ).
2. Product anchors shall be as listed and spaced as shown on details. Anchor embedment to base material shall be beyond wall dressing or stucco.
3. When used in areas requiring wind borne debris protection this product complies with FBC Sections 1609.1.2 & R301.2.1.2 and does not require an impact resistant covering. This product meets missile level "D" and includes Wind Zone 4 as defined in ASTM E1996 and FBC Sections 1609.1.2.2 & R301.2.1.2.1.
4. For 2x stud framing construction, anchoring of these units shall be the same as that shown for 2x buck masonry construction.
5. Site conditions that deviate from the details of this drawing require further engineering analysis by a licensed engineer or registered architect.
6. Note: Fire rating of this door is not part of this approval.

TABLE OF CONTENTS

SHEET#	DESCRIPTION
1	Typical elevations, design pressures & general notes
2	Door panel details
3	Elevations
4	Horizontal Cross Sections
5	Vertical Cross Sections
6	Buck and frame anchoring
7	Bill of materials and components

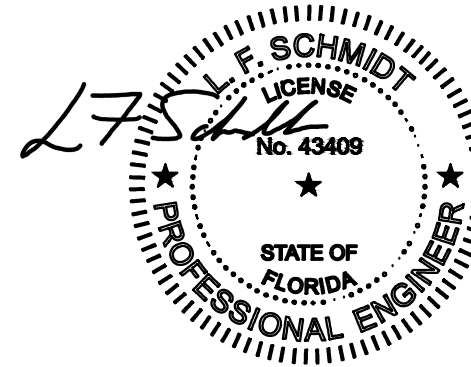

This item has been digitally signed and sealed by L. F. Schmidt, P.E. on the date adjacent to the seal. Printed copies of this document are not considered signed and sealed and the signature must be verified on any electronic copies.

THIS PRODUCT APPROVAL IS VALID ONLY FOR THE STATE OF FLORIDA

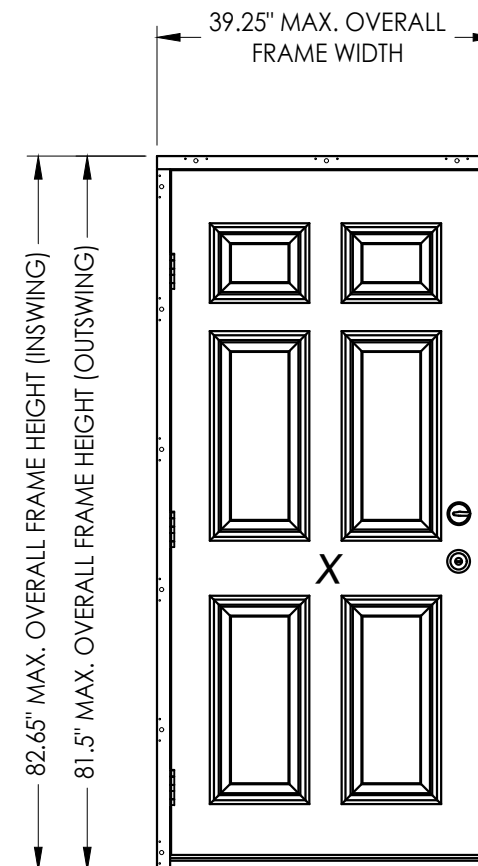

CONFIGURATION	MAX. FRAME DIMENSION	DESIGN PRESSURE (PSF) INSWING		DESIGN PRESSURE (PSF) OUTSWING	
		POSITIVE	NEGATIVE	POSITIVE	NEGATIVE
X	39.25" x 82.65"	+67.0	-67.0	+67.0	-67.0

Documents Prepared By:
Lyndon F. Schmidt
P.E. No. 43409

RW BUILDING CONSULTANTS, INC.
P.O. Box 230, Valrico, FL 33595
Phone No.: 813.659.9197
FBPE Registry No. 9813

PRODUCT: THERMA-TRU FIBERGLASS DOOR
PART OR ASSEMBLY: TYPICAL ELEVATION, DESIGN PRESSURES & GENERAL NOTES

NO.	DATE	REVISIONS
2	8/22/23	UPDATE TO 8TH ED. (2023) FBC
1	7/15/20	UPDATE TO 7th ED (2020) FBC

DATE: 7/25/19
SCALE: N.T.S.
DWG. BY: RW
CHK. BY: LFS
DRAWING NO.: FL-21138.18
SHEET 1 of 7

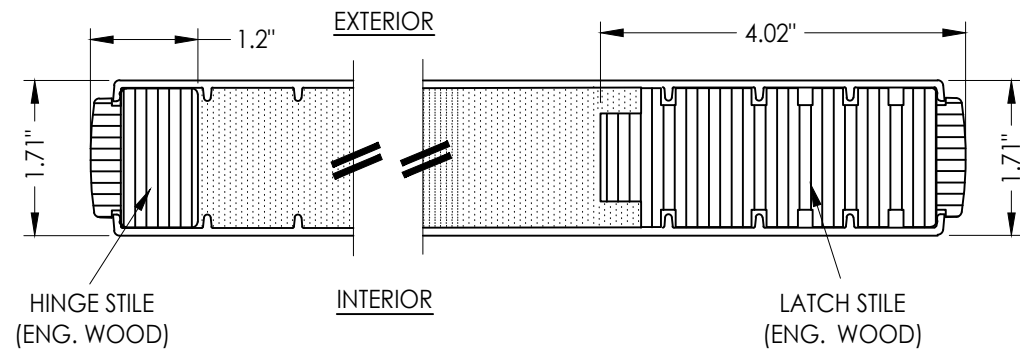

1
2 HORIZONTAL CROSS SECTION

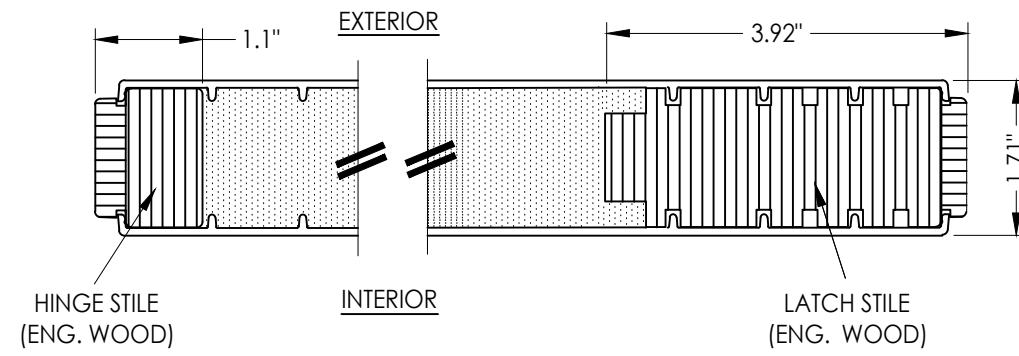

2
2 HORIZONTAL CROSS SECTION

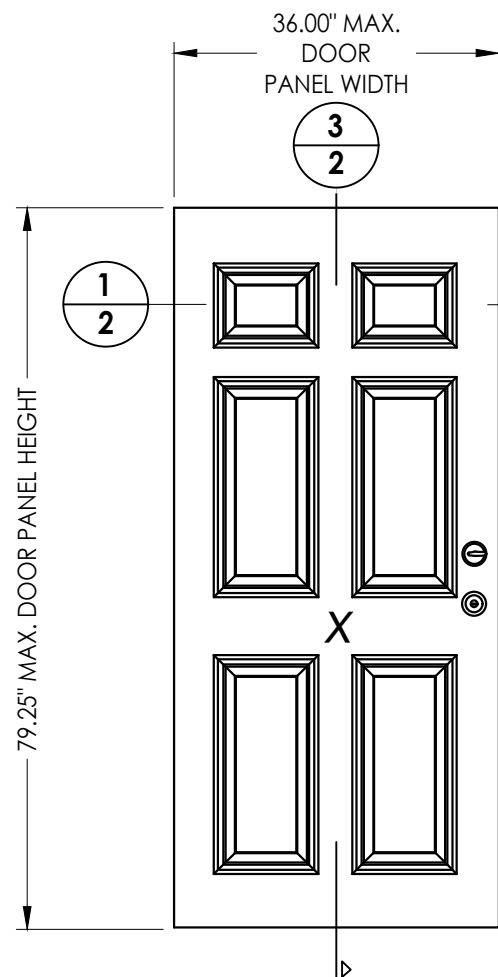

40 DOOR PANEL BOOK

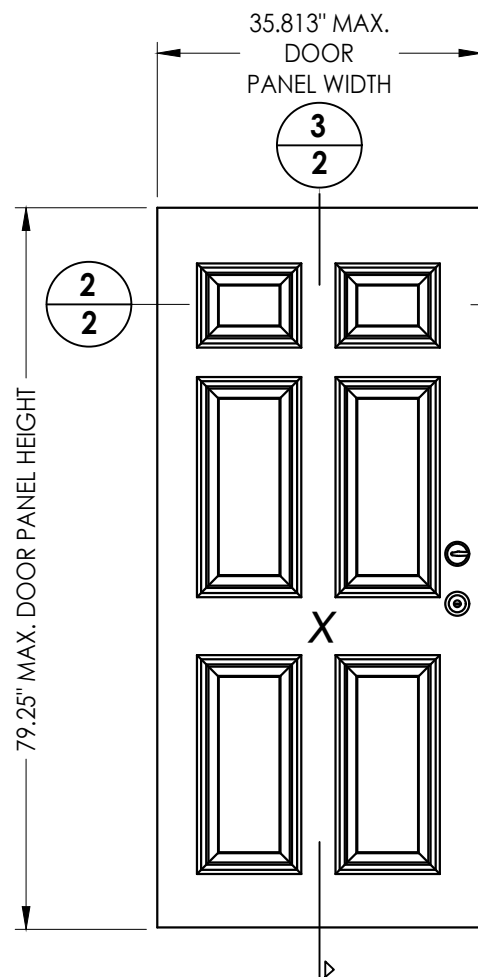

41 DOOR PANEL Hybrid Door

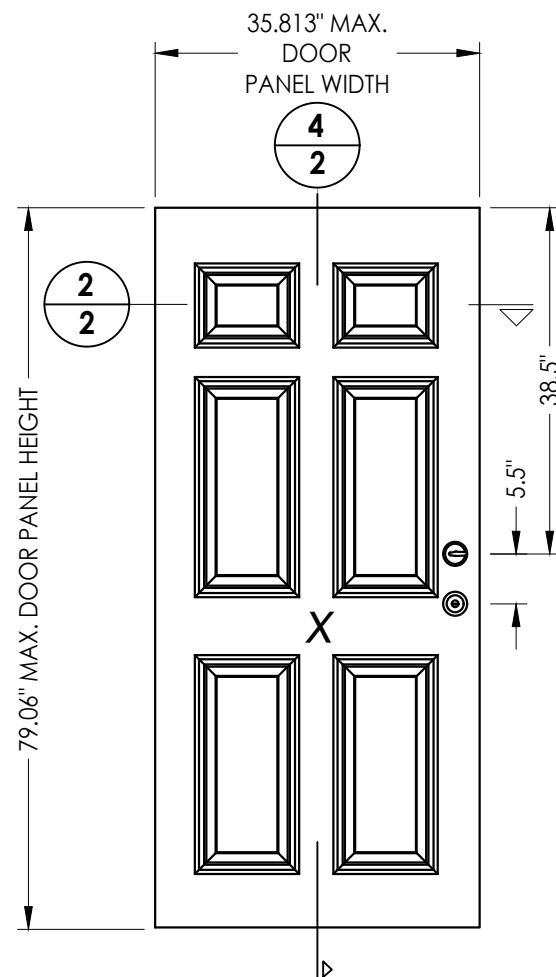

42 DOOR PANEL U1 Door

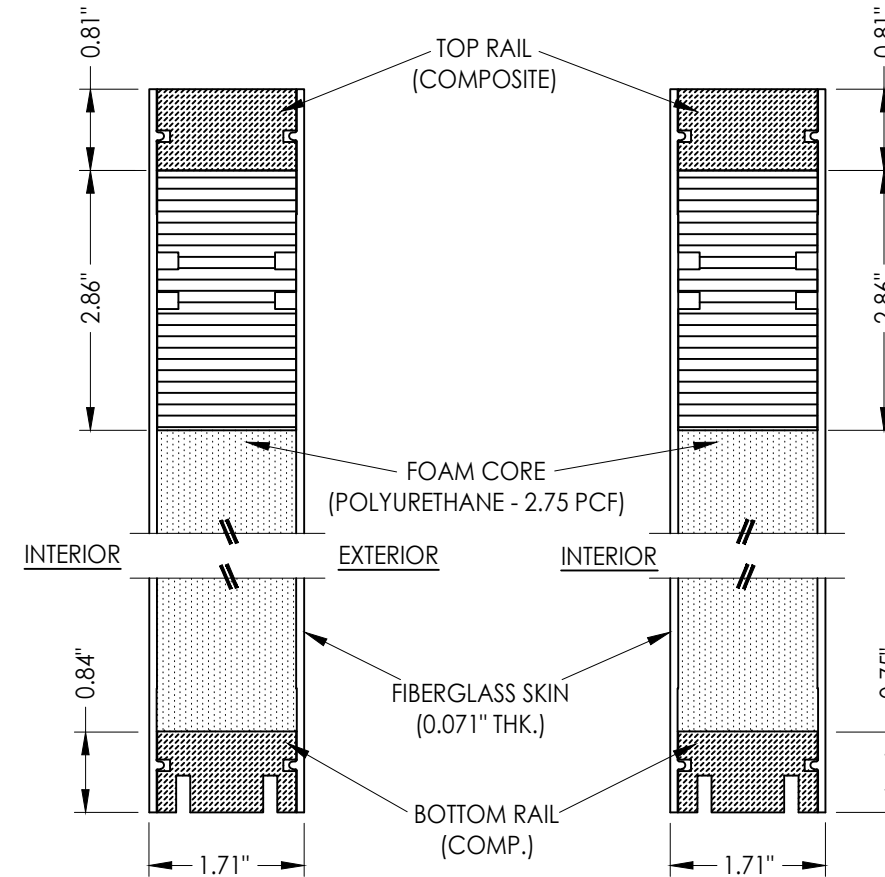

3
2 VERTICAL CROSS SECTION

4
2 VERTICAL CROSS SECTION

Documents Prepared By:
Lyndon F. Schmidt
P.E. No. 43409

RW BUILDING CONSULTANTS, INC.
P.O. Box 230, Valrico, FL 33595
Phone No.: 813.659.9197
FBPE Registry No. 9813

PRODUCT: THERMA-TRU FIBERGLASS DOOR
PART OR ASSEMBLY: DOOR PANEL DETAILS

NO.	DATE	BY
2	8/22/23	LFS
1	7/15/20	PO

DATE:	7/25/19
SCALE:	N.T.S.
DWG. BY:	RW
CHK. BY:	LFS
DRAWING NO.:	FL-21138.18
SHEET	2 OF 7

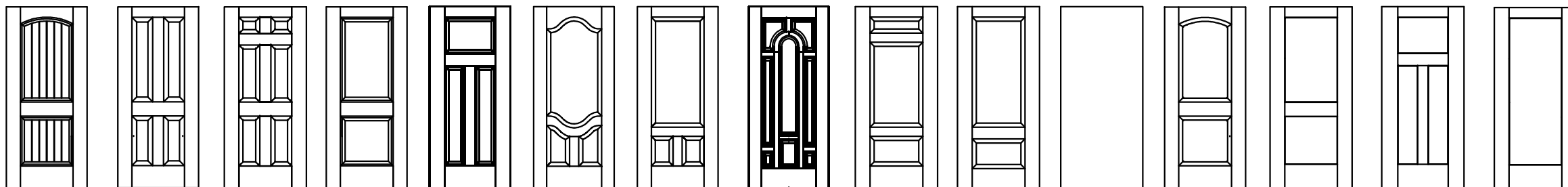

Fiber-Classic/Smooth-Star Door Panel Options

Products approved include all embossed and recessed panel doors.
 Similar opaque panel configurations are allowed.
 Panels shown are for illustration and are representative only.

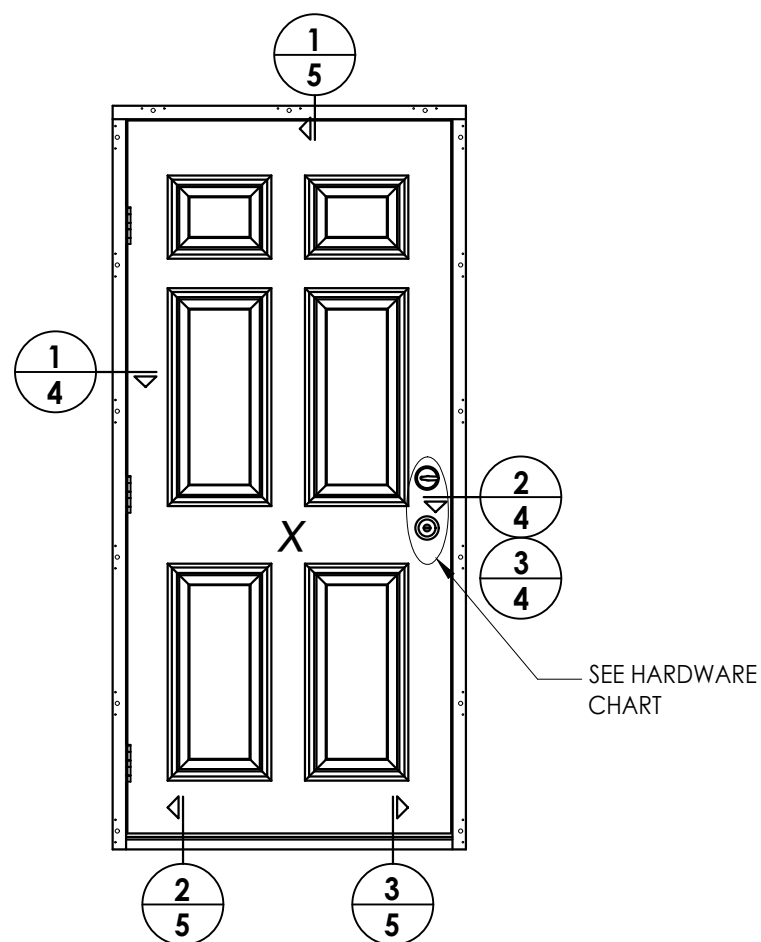

HARDWARE TABLE	
MANUFACTURER	MODEL
KWIKSET	KNOB: SIGNATURE SERIES
	DEADBOLT: SIGNATURE SERIES (980)
SCHLAGE	KNOB: "F" SERIES
	DEADBOLT: "B" SERIES (B60)

DATE:	7/25/19
SCALE:	N.T.S.
DWG. BY:	RW
CHK. BY:	LFS
DRAWING NO.:	FL-21138.18
SHEET	3 OF 7

REVISIONS	
NO.	DATE
2	8/22/23
1	7/15/20

PRODUCT:	THERMA-TRU FIBERGLASS DOOR
PART OR ASSEMBLY:	ELEVATIONS

Documents Prepared By:
 Lyndon F. Schmidt
 P.E. No. 43409

RW BUILDING CONSULTANTS, INC.
 P.O. Box 230, Valrico, FL 33595
 Phone No.: 813.659.9197
 FBPE Registry No. 9813

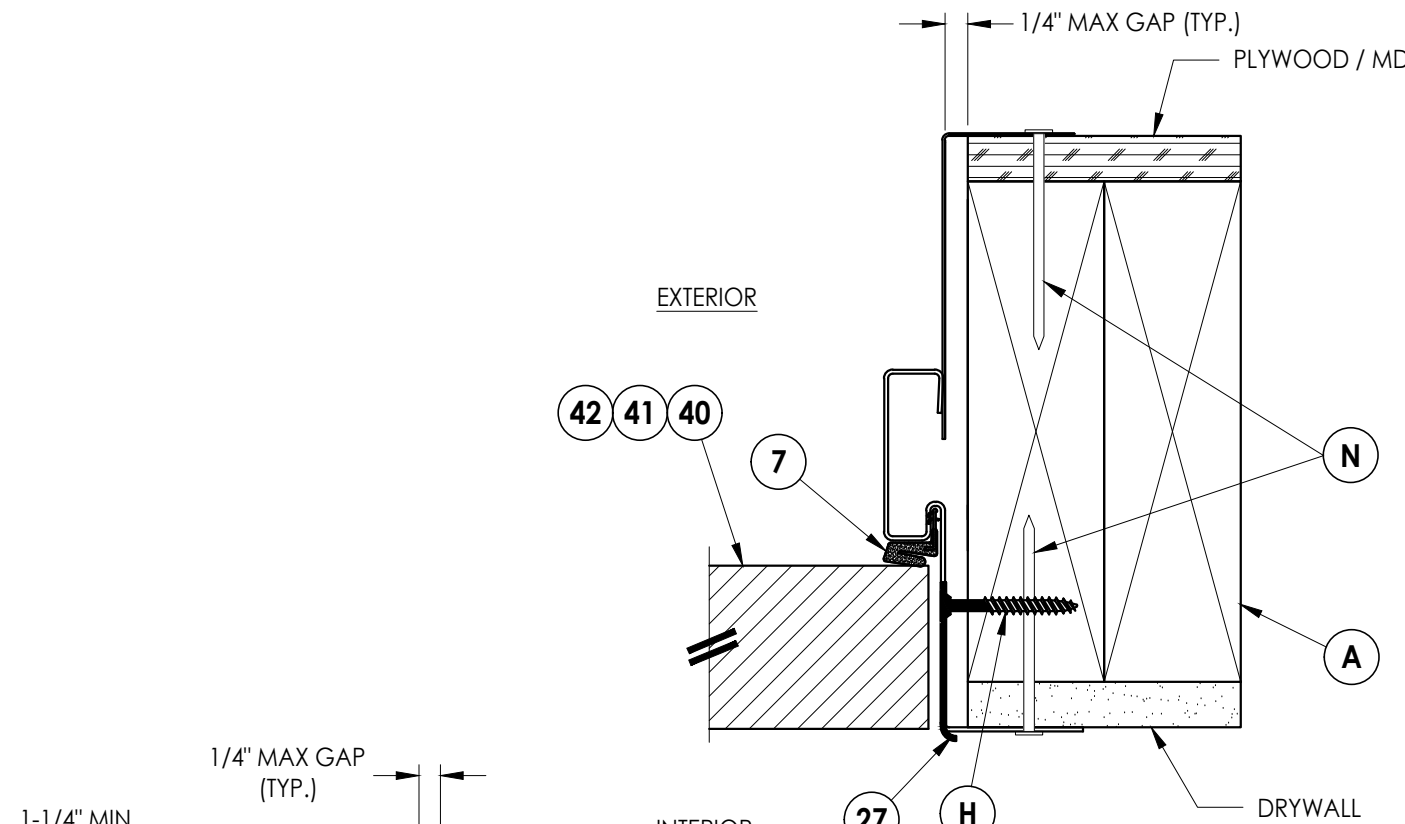

3 HORIZONTAL CROSS SECTION
 4 Shown w/ 2X Framing
 Inswing shown (Outswing similar)

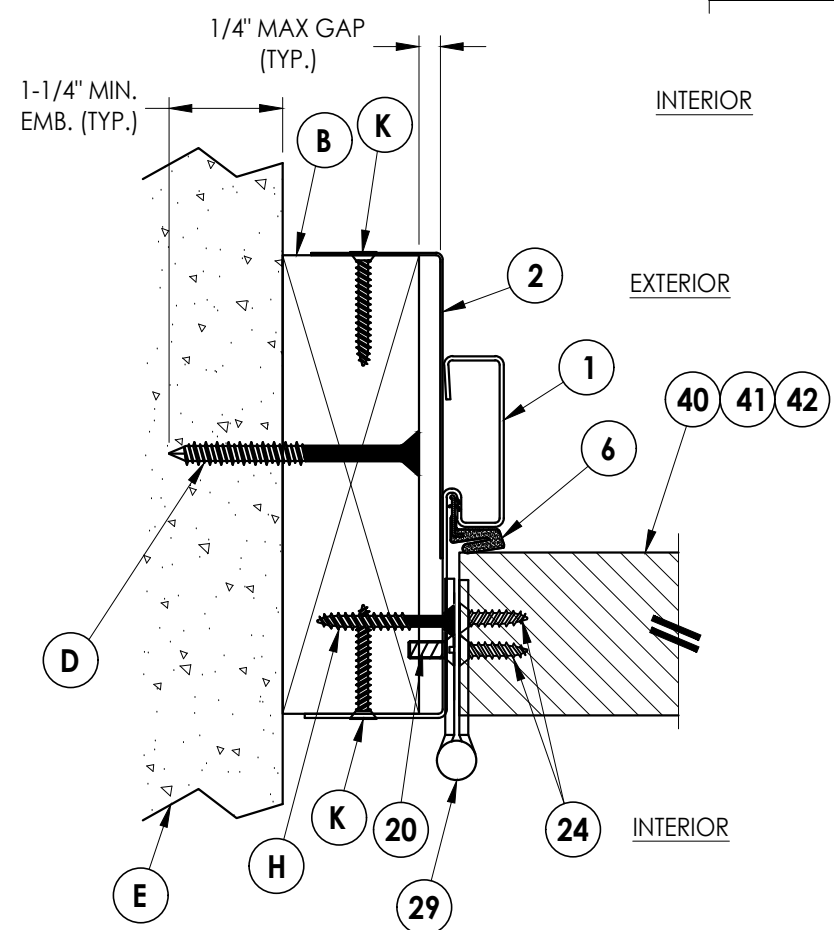

1 HORIZONTAL CROSS SECTION
 4 Shown w/ 2X Buck
 Outswing shown (Inswing similar)

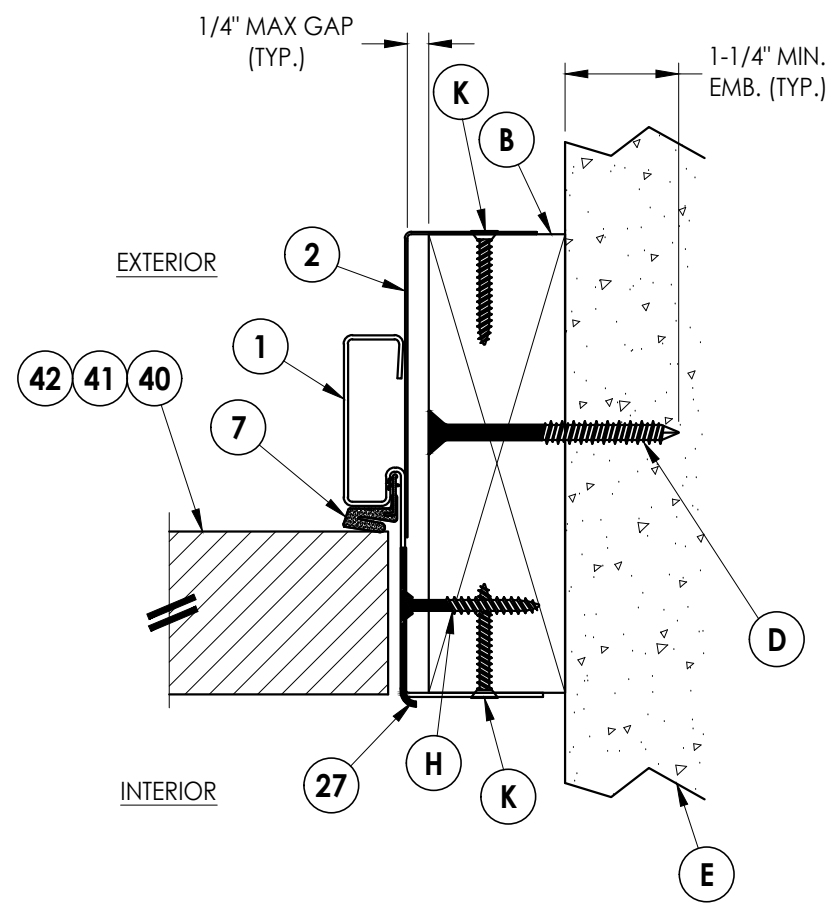

2 HORIZONTAL CROSS SECTION
 4 Shown w/ 2X Framing
 Inswing shown (Outswing similar)

Documents Prepared By:
 Lyndon F. Schmidt
 P.E. No. 43409

RW BUILDING CONSULTANTS, INC.
 P.O. Box 230, Valrico, FL 33595
 Phone No.: 813.659.9197
 FBPE Registry No. 9813

PRODUCT:
 THERMA-TRU
 FIBERGLASS DOOR

PART OR ASSEMBLY:
 HORIZONTAL
 CROSS SECTIONS

NO.	DATE	BY
2	8/22/23	LFS
1	7/15/20	PO
REVISIONS		

DATE:	7/25/19
SCALE:	N.T.S.
DWG. BY:	RW
CHK. BY:	LFS
DRAWING NO.:	FL-21138.18
SHEET	4 OF 7

Z:\2023_EBC_Drawings\Therma-Tru\FL-21138_RZ\FI-21138_18.dwg

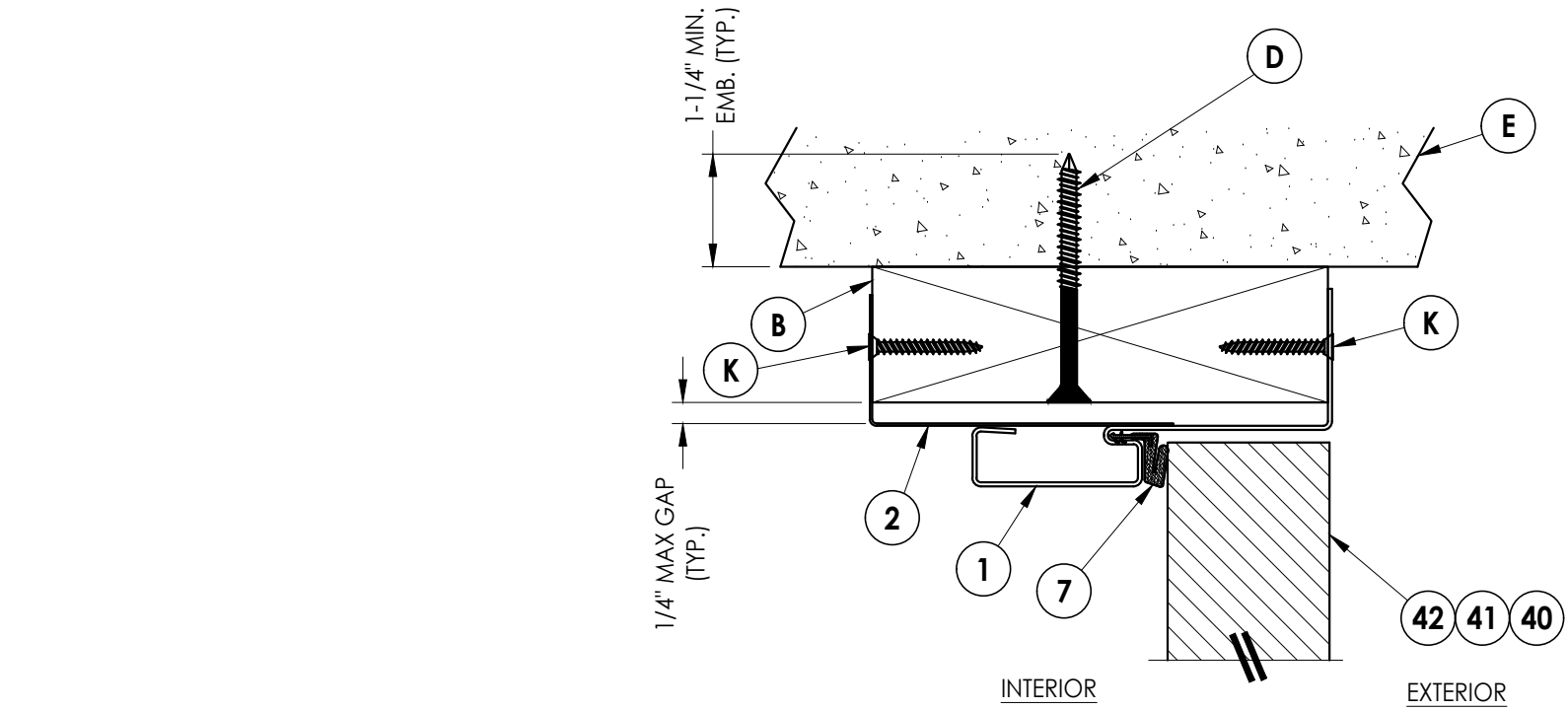

1 VERTICAL CROSS SECTION
5 Shown w/ 2X Buck
 Outswing shown (Inswing similar)

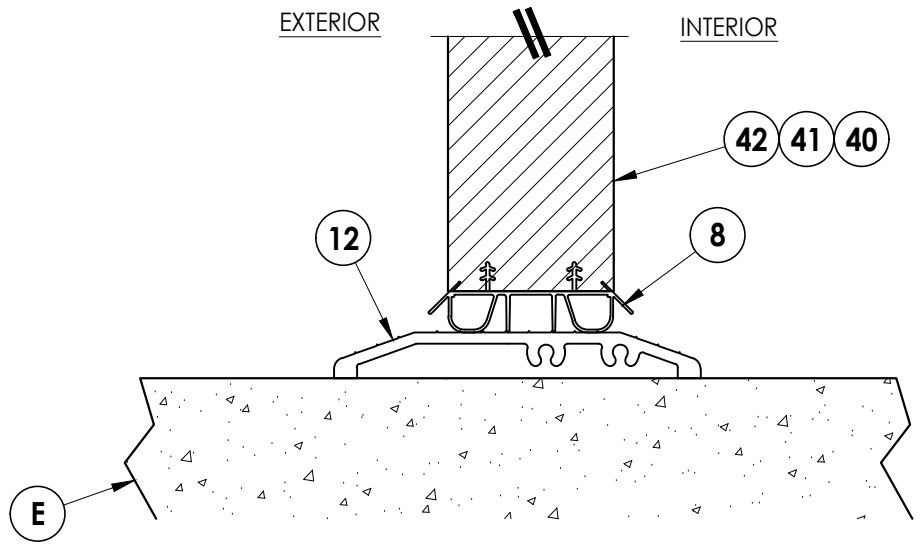

2 VERTICAL CROSS SECTION
5 Outswing configuration

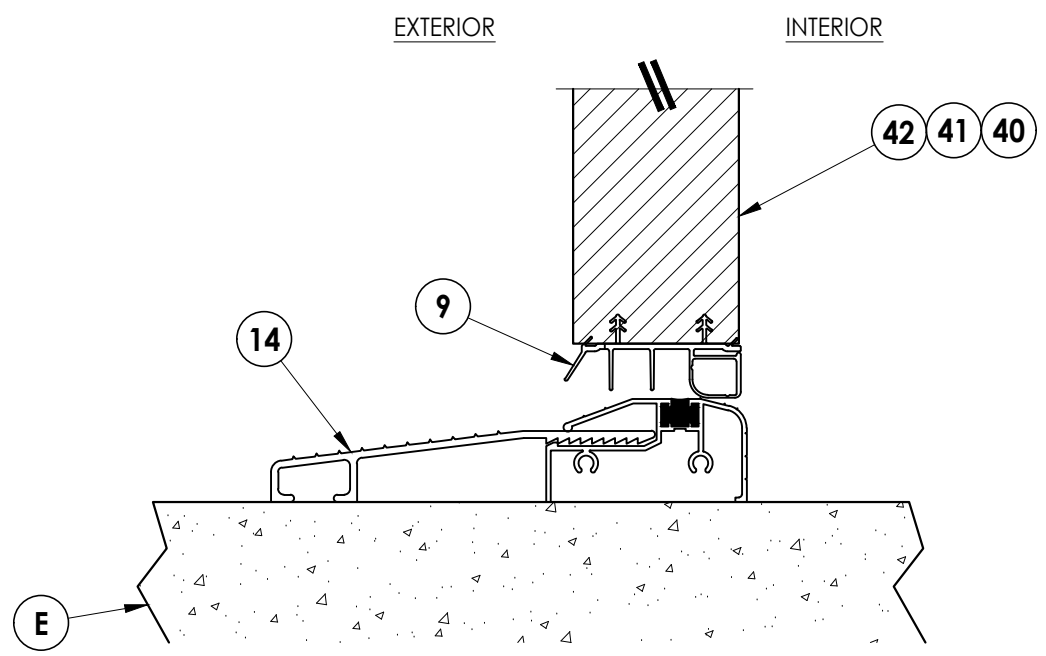

3 VERTICAL CROSS SECTION
5 Inswing configuration

Documents Prepared By: Lyndon F. Schmidt P.E. No. 43409			BUILDING CONSULTANTS, INC. P.O. Box 230, Vairico, FL 33595 Phone No.: 813.659.9197 FBPE Registry No. 9813		
PRODUCT: THERMA-TRU FIBERGLASS DOOR		PART OR ASSEMBLY: VERTICAL CROSS SECTIONS			
			LFS	PO	BY
			8/22/23	UPDATE TO 8TH ED. (2023)	FBC
			7/15/20	UPDATE TO 7th ED (2020)	FBC
			NO.	DATE	REVISIONS
DATE: 7/25/19					
SCALE: N.T.S.					
DWG. BY: RW					
CHK. BY: LFS					
DRAWING NO.: FL-21138.18					
SHEET 5 of 7					

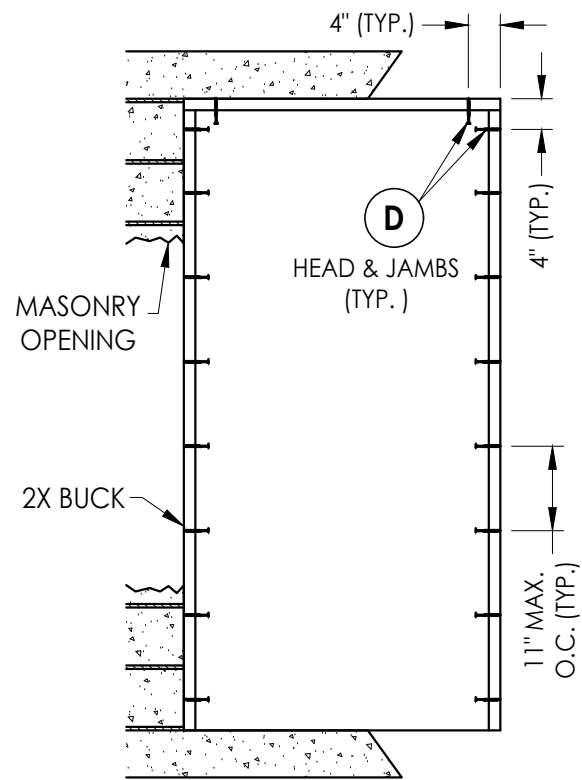

BUCK ANCHORING
Max. Design Pressure = 100 PSF

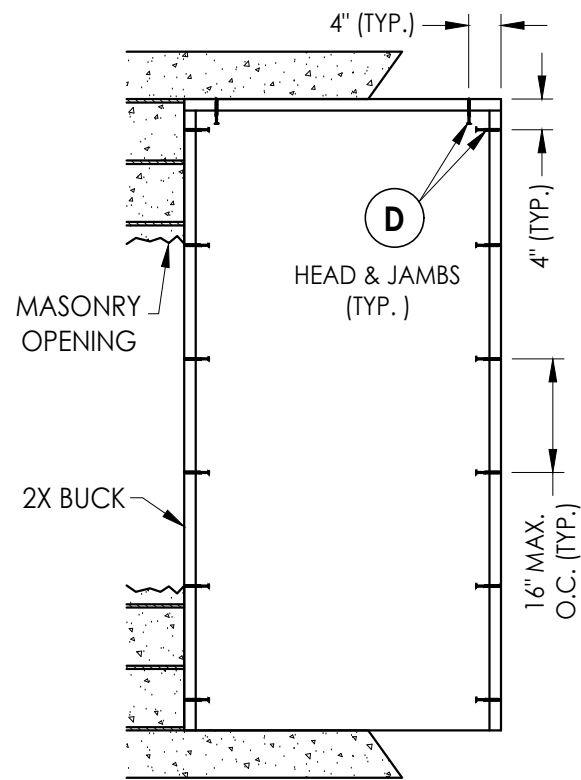

BUCK ANCHORING
Max. Design Pressure = 60 PSF

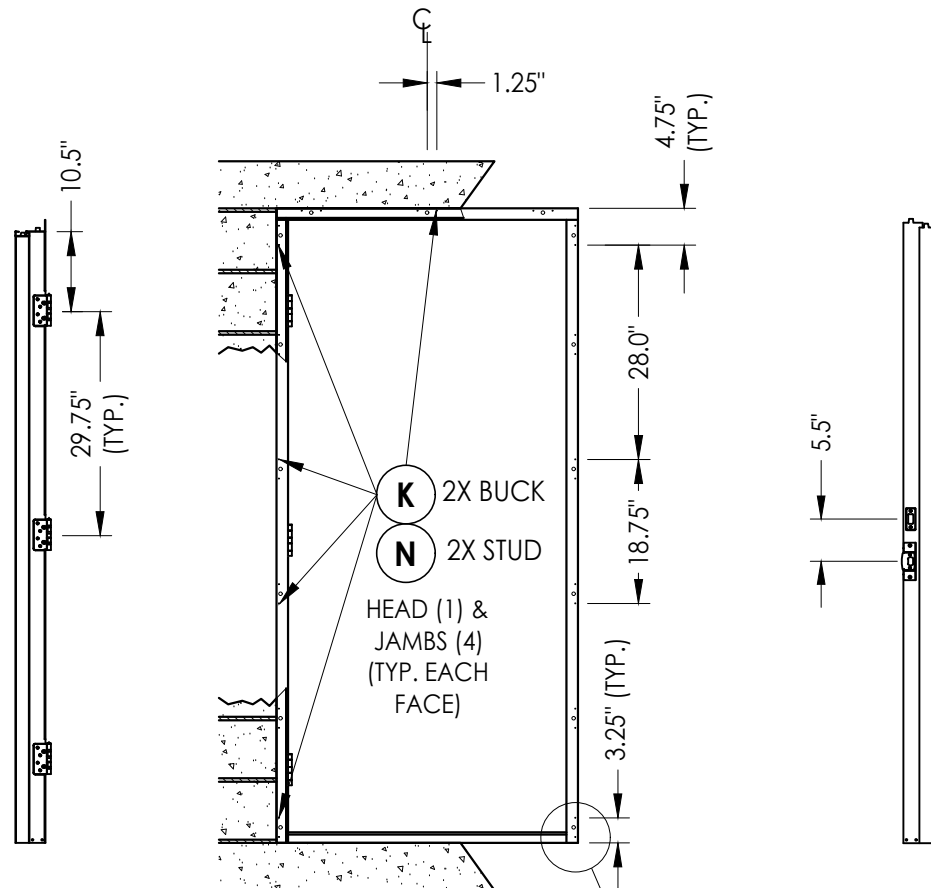

HINGE JAMB

FRAME ANCHORING
Masonry Construction

STRIKE JAMB

TYP. ALL BOTTOM CORNERS

25 JAMB TO SILL (TYP.)

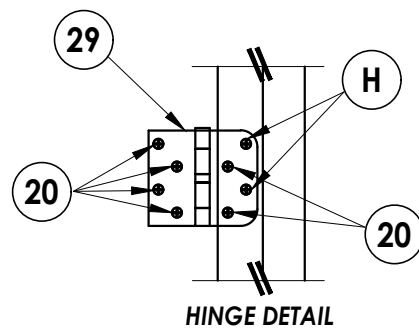

HINGE DETAIL

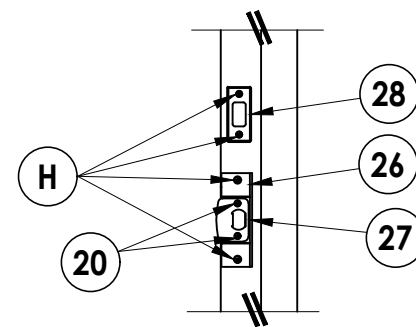

LATCH & DEADBOLT DETAIL

Documents Prepared By:
Lyndon F. Schmidt
P.E. No. 43409

RW BUILDING CONSULTANTS, INC.
P.O. Box 230, Valrico, FL 33595
Phone No.: 813.659.9197
FBPE Registry No. 9813

PRODUCT:
THERMA-TRU
FIBERGLASS DOOR

PART OR ASSEMBLY:
BUCK & FRAME ANCHORING

NO.	DATE	REVISIONS
2	8/22/23	UPDATE TO 8TH ED. (2023) FBC LFS
1	7/15/20	UPDATE TO 7TH ED. (2020) FBC PO
		BY

DATE: 7/25/19

SCALE: N.T.S.

DWG. BY: RW

CHK. BY: LFS

DRAWING NO.:
FL-21138.18

SHEET 6 OF 7

BILL OF MATERIALS		
ITEM #	DESCRIPTION	MATERIAL
A	2X STUD (SG >= 0.42)	WOOD
B	2X BUCK (SG >= 0.42)	WOOD
D	1/4" X 2-3/4" PFH DeWALT OR ITW CONCRETE SCREW	STEEL
E	MASONRY - 3,000 PSI MIN. CONCRETE CONFORMING TO ACI 301 OR HOLLOW BLOCK CONFORMING TO ASTM C90	CONCRETE
H	#10 X 1-1/2" PFH WOOD SCREW (1.15" MIN. EMBEDMENT)	STEEL
K	#8 X 1-1/4" PPH WOOD SCREW (1.15" MIN. EMBEDMENT)	STEEL
N	8d X 2-1/2" COMMON NAIL (1.75" MIN. EMBEDMENT)	STEEL
1	FRAME	STEEL
2	FRAME CLOSER	STEEL
6	WEATHERSTRIP (MEDIUM REACH)	FOAM
7	WEATHERSTRIP (LONG REACH)	FOAM
8	SWEEP	VINYL
9	SWEEP	VINYL
12	PUBLIC ACCESS THRESHOLD	ALUM
14	INSWING THRESHOLD	ALUM
20	#10 x 1/2" THREAD CUTTING MACHINE SCREW	STEEL
24	#10 x 1" PFH WOOD SCREW	STEEL

BILL OF MATERIALS		
ITEM #	DESCRIPTION	MATERIAL
25	#8 x 2-1/2" PFH WOOD SCREW	STEEL
26	LATCH ADAPTOR	STEEL
27	LATCH STRIKE PLATE	STEEL
28	DEADBOLT STRIKE PLATE	STEEL
29	4" X 4" HINGE	STEEL
40	DOOR PANEL (BOOK)	-
41	DOOR PANEL (HYBRID)	-
42	DOOR PANEL (U1)	-

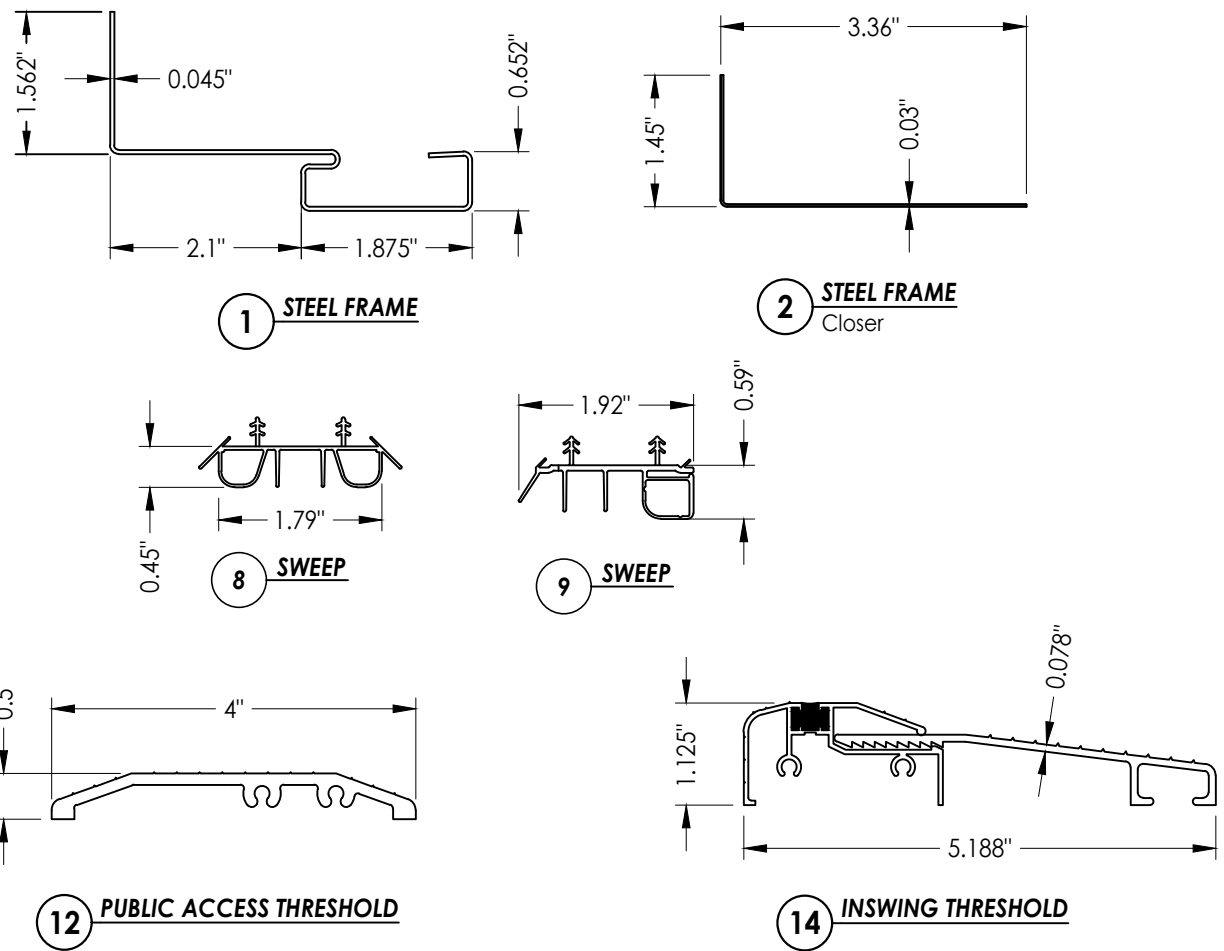

CONCRETE ANCHOR NOTES:

- Concrete anchor locations at the corners may be adjusted to maintain the min. edge distance to mortar joints.
- Concrete anchor locations noted as "MAX. ON CENTER" must be adjusted to maintain the min. edge distance to mortar joints, additional concrete anchors may be required to ensure the "MAX. ON CENTER" dimension are not exceeded.
- Concrete anchor table:

ANCHOR TYPE	ANCHOR SIZE	MIN. EMBEDMENT	MIN. CLEARANCE TO MASONRY EDGE	MIN. CLEARANCE TO ADJACENT ANCHOR
ITW TAPCON®	1/4"	1-1/4"	2"	4"
DeWALT ULTRACON®	1/4"	1-1/4"	1"	4"
ITW TAPCON®	3/16"	1-1/4"	AS SHOWN	1-1/2"

WOOD SCREW INSTALLATION NOTES:

- Maintain a minimum 5/8" edge distance, 1" end distance, & 1" o.c. spacing of wood screws to prevent the splitting of wood.

Documents Prepared By:
Lyndon F. Schmidt
P.E. No. 43409

RW BUILDING CONSULTANTS, INC.
P.O. Box 230, Vairico, FL 33595
Phone No.: 813.659.9197
FBPE Registry No. 9813

PRODUCT: THERMA-TRU FIBERGLASS DOOR

PART OR ASSEMBLY: BILL OF MATERIALS AND COMPONENTS

NO.	DATE	REVISIONS
2	8/22/23	UPDATE TO 8TH ED. (2023) FBC
1	7/15/20	UPDATE TO 7th ED. (2020) FBC
		NO DATE

DATE: 7/25/19
SCALE: N.T.S.
DWG. BY: RW
CHK. BY: LFS
DRAWING NO.: FL-21138.18
SHEET 7 OF 7